

# Where the lines are drawn

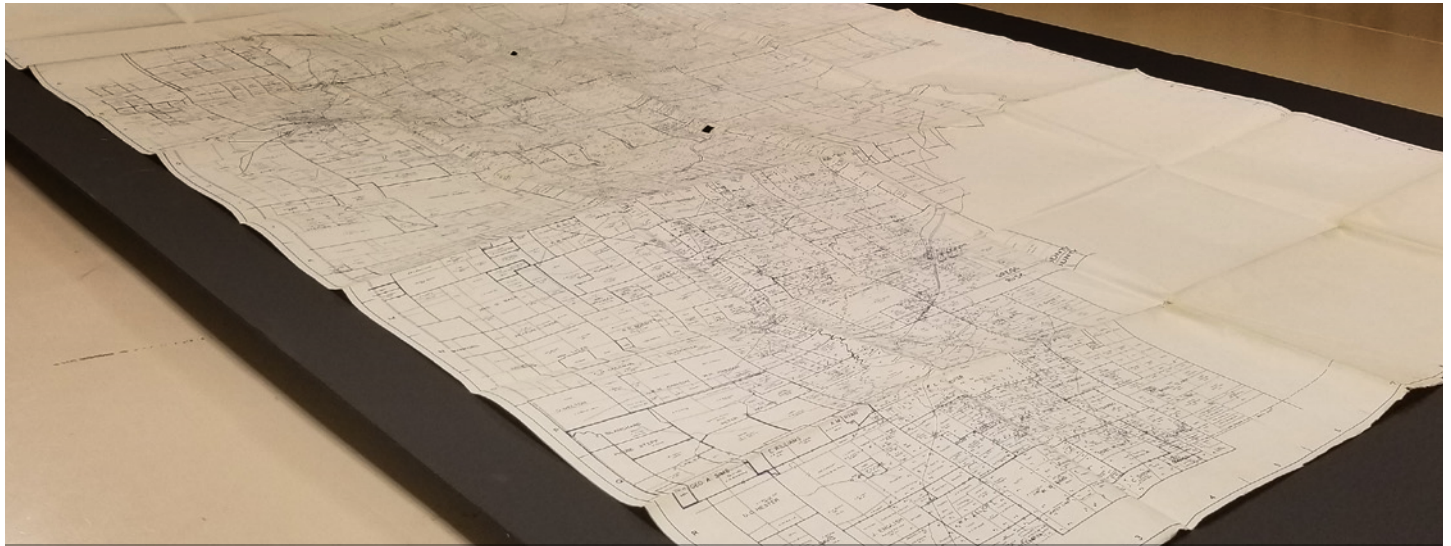

**PRODUCTS:** HD Ultra X, ScanStation PRO and Nextimage 5 software

## CHALLENGE

More than 45,000 maps, sketches, and surveying documents reside at the General Land Office in Texas, too far away for most to view in person. In 2000, the organization embarked on a large-scale project to share these documents online. The project was fruitful, but efficiently capturing the agency's oversized documents remained a challenge.

## SOLUTION

A Contex HD Ultra X 60-inch CCD scanning solution has helped staffers reduce pre-scanning preparation and significantly boosted the scanning workflow. The extra-wide scanner can easily handle the oversized documents that once took up to 6 people in its ScanLab to manage.

## RESULTS

Today, the General Land Office's ScanLab is 25% more efficient than ever. The team is able to post more of its archive of maps, sketches, and surveys for online viewing and for purchase. Increased revenue opportunities helps to preserve the archive for future generations to enjoy.



**We needed a scanner that could rapidly generate accurate images of more than 45,000 maps – complete with stains, creases, and faded colors – without an operator having to spend an inordinate amount of time adjusting each one.**

*Susan Smith Dorsey,  
Director and Records Management Officer,  
Texas General Land Office*

## Background

In the early 1800s, the new Republic of Texas was saddled with scores of debts and no means to settle them. In lieu of monetary payment, the republic issued its creditors land grants. Expertly crafted maps delineated property lines for new owners. By 1836, more than 4,200 land grants were issued, and the state established the Texas General Land Office (GLO) to watch over and protect these documents, which now exceed 36.5 million hard copy records and 45,000 maps, sketches, and surveying documents.

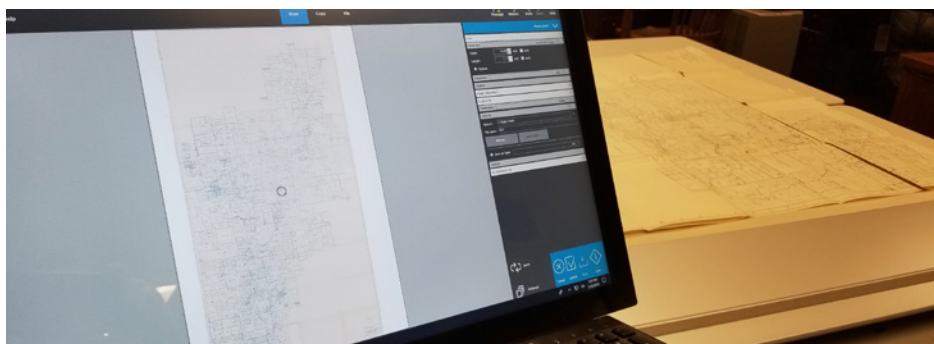
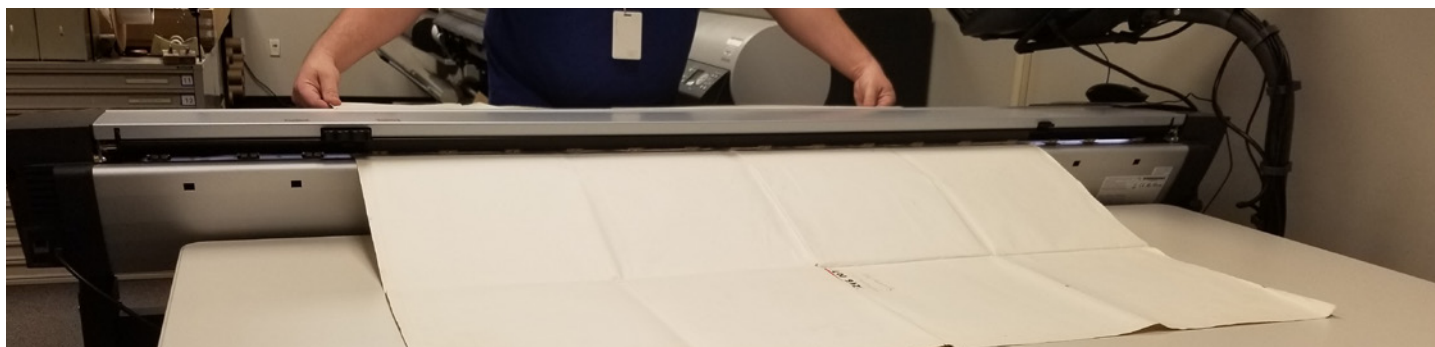

The General Land Office uses the Contex HD Ultra X scanning solution to preserve its array of maps, sketches, and surveying documents — up to 60-inches wide.

Contex's advanced technology helps to save valuable time in the scanning workflow, and the scanned images are so accurate that they rarely require editing.

**CHALLENGE**

**Going back in time**

While digitizing volumes of files can be a daunting undertaking, the pressure mounts when preserving extremely valuable and delicate one-of-a-kind originals. To save the cache of precious records, a major preservation project was launched to build a digital archive.

In 2000, the GLO invested in its first Contex large format scanner. For nearly two decades, the Contex scanner delivered the required image quality while protecting the delicate

originals. When Contex introduced the HD Ultra X large format scanner, the GLO knew it was time to upgrade.

**SOLUTION**

**Boosting the scanning workflow**

Thanks to the guidance of scanning expert Doyle Cryer and the DIR cooperative contract that streamlines the purchasing process for state agencies, the GLO acquired a Contex HD Ultra X 60-inch CCD scanner with a ScanStation PRO, Nextimage scanning software, and a 21.5" touch screen monitor. The HD Ultra X is

Contex's fastest scanner, with a top speed of 17.8 ips.

With the unprecedented scanning speed and workflow enhancements, the HD Ultra X scanning solution is boosting the GLO's productivity by 25%. Thanks to true size detection, the Contex scanner wastes no time initiating the scanning process, and the floating transport design of the glass plate minimizes friction and reduces upkeep. The image quality of the scans is so accurate that they rarely require editing.



The HD Ultra X is ultra-fast, and we are able to produce the highest-quality scans the market has to offer, which says a lot about the quality of the Contex scanner.

*Jonathan Palmer, Team Lead for the ScanLab, General Land Office*

**RESULTS**

**For the Whole World to See**

Some of the oldest documents in the GLO archive date back to the early 1500s. Once only accessible to onsite visitors, the GLO online repository is easily available to anyone in the world. Researchers, surveyors, title companies, historians, and more can quickly locate and order reproductions of the scanned maps with just a few clicks.

**SEE MORE:** [contex.com/hdultrax](http://contex.com/hdultrax) · [contex.com/scanstationpro](http://contex.com/scanstationpro) · [contex.com/nextimage-software](http://contex.com/nextimage-software)

**Contex HQ & EMEA**  
Global Scanning Denmark A/S  
Copenhagen, Denmark  
Phone: +45 4814 1122  
info@contex.com

**Contex Americas**  
Global Scanning Americas (MD) Inc.  
Chantilly, VA. 20151, USA  
Phone: +1 (703) 964 9850  
salesamericas@contex.com

**Contex Japan & Asia**  
Global Scanning Japan A/S  
Yokohama, Japan  
Phone: +81 45 548 8547  
apac@contex.com

